

257 GREENWAY ROAD
LOT - 16
BLOCK - 2802

LOT AREA
 22,498 SF

LOT COVERAGE INFORMATION

TOTAL EXISTING - 8,000 SF

- HOUSE - 2,357 SF
- POOL AREA - 1,984 SF
- DRIVEWAY TO BACK - 3,462 SF
- SHED - 197 SF

NEW PROPOSED CIRCULAR DRIVEWAY
 1,835 SF

NEW PROPOSED PAVED SURFACE
 414 SF

NEW TOTAL LOT COVERAGE
 10,249 SF (45.56%)

LEGEND

- EXISTING TO REMAIN
- NEW PROPOSED CIRCULAR DRIVEWAY & PAVED SURFACE
- EXISTING TO BE MODIFIED
- NEW CONCRETE APRON

SCALE: 1/16" = 1'-0"

| | |
|---------------------------------|---------------|
| VARIANCE APPLICATION SUBMISSION | JULY 17, 2025 |
| APPLICATION REVISION | AUG. 28, 2025 |

JISOO SUZY YOON
 257 GREENWAY ROAD RIDGEWOOD, NJ 07450
 201-602-4224
 jisoo.suzy.yoon@gmail.com

NJ LICENSE # 21A102205100

APPLICANT AND OWNER
 JISOO SUZY YOON
 257 GREENWAY ROAD
 RIDGEWOOD, NJ 07450

VARIANCE APPLICATION

257 GREENWAY ROAD
 RIDGEWOOD, NJ 07450
 BERGEN COUNTY

LOT 16
 BLOCK 2806

Seal

JY

Drawing Title
PROPOSED DRIVEWAY PLAN / INFORMATION

Scale
AS NOTED

Issue Date
AUGUST 28, 2025

Signature of Chairman

Signature of Secretary of the Board

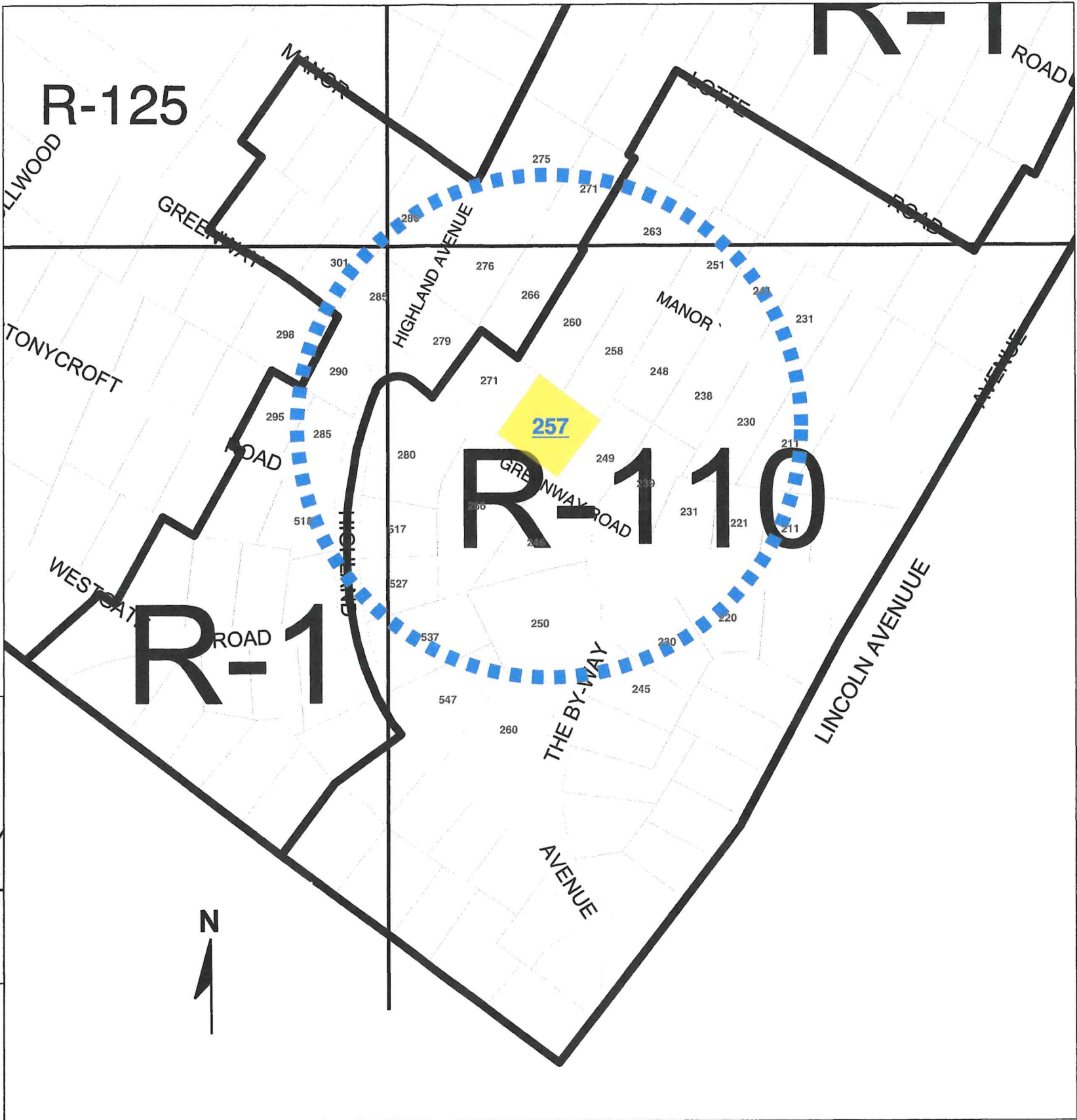
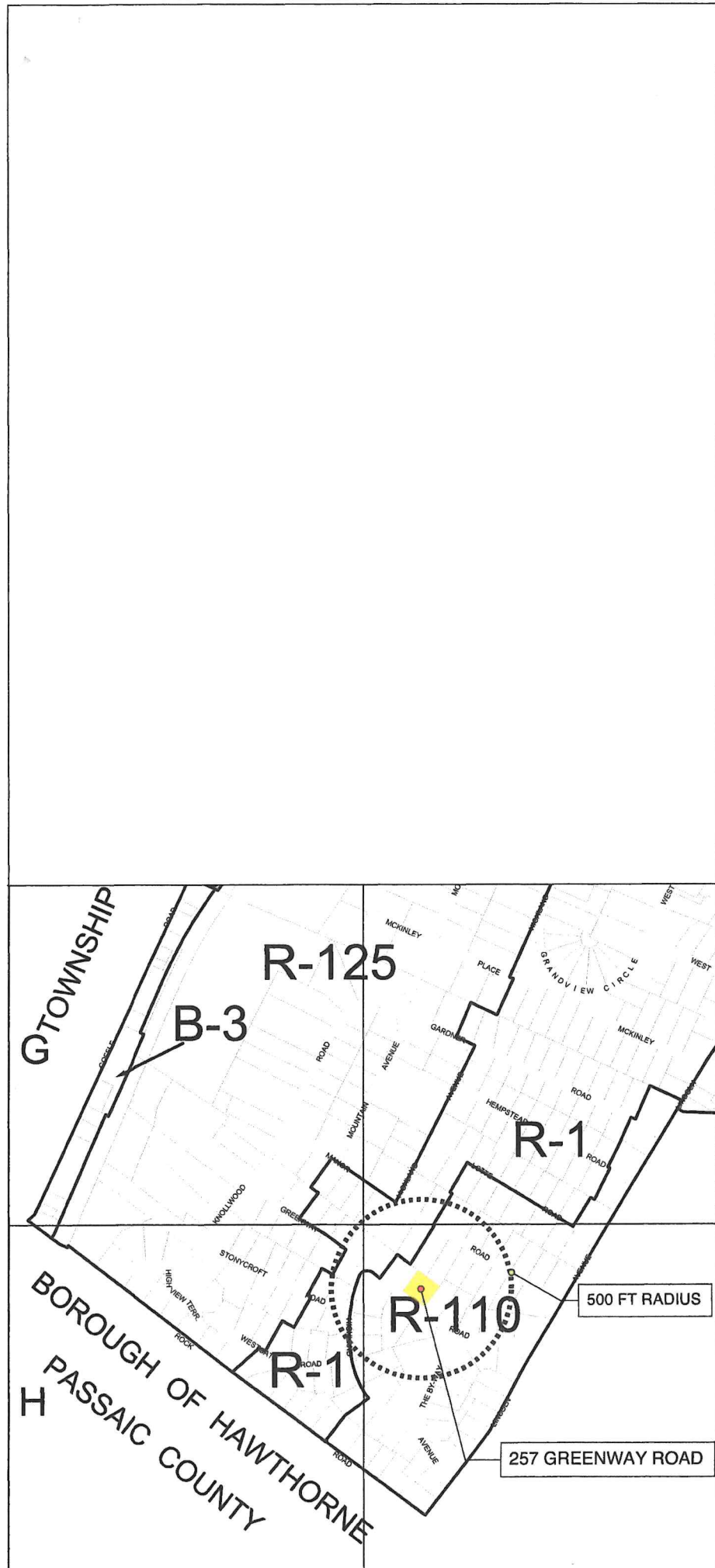

KEY MAP



| | |
|---------------------------------|---------------|
| VARIANCE APPLICATION SUBMISSION | JULY 17, 2025 |
| APPLICATION REVISION | AUG. 28, 2025 |

JISOO SUZY YOON
 257 GREENWAY ROAD RIDGEWOOD, NJ 07450
 201-602-4224
 jisoo.suzy.yoon@gmail.com
 NJ LICENSE # 21A102205100

APPLICANT AND OWNER
 JISOO SUZY YOON
 257 GREENWAY ROAD
 RIDGEWOOD, NJ 07450

VARIANCE APPLICATION

257 GREENWAY ROAD
 RIDGEWOOD, NJ 07450
 BERGEN COUNTY

LOT 16
 BLOCK 2806

Seal

JS

Drawing Title **KEY MAP**

Scale **NTS**

Issue Date **AUGUST 28, 2025**

Signature of Chairman

Signature of Secretary of the Board